

Les modules réalisés par les élèves

<http://spiderwan.free.fr/projet-impression3D>

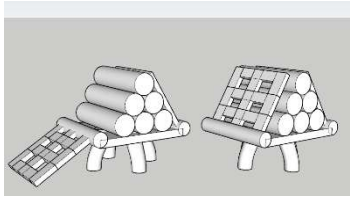

Les réserves de gaz



La serre de culture

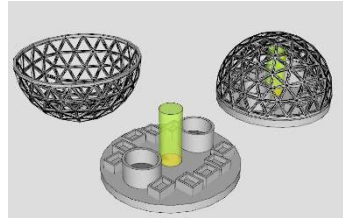

La serre de spiruline

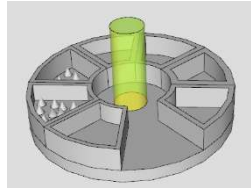

La porte des sas

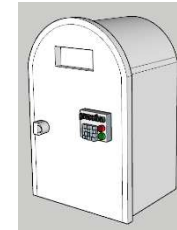

Module : formule de Sabatier pour faire du méthane et de l'eau

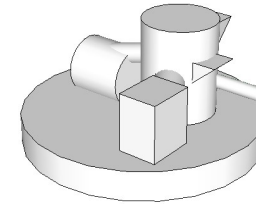

Le sas redondant

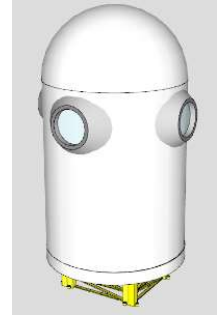

Le sas de traitement du régolithe

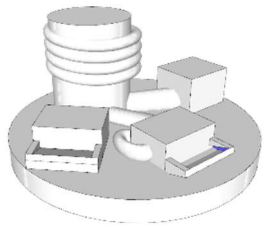

Le sas inter module

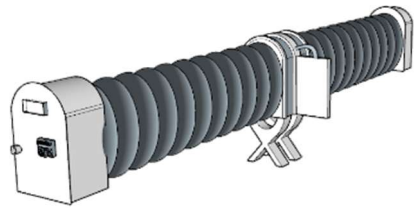

Le sas inter module

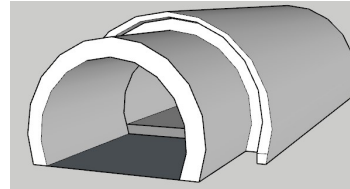

Le sas de secours gonflable du tunnel de lave

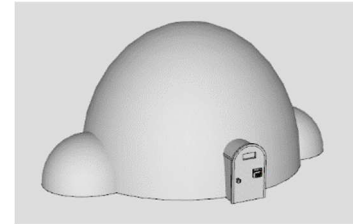

Le module hydrolyse de l'eau

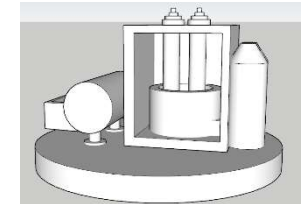

Le module pile à combustible

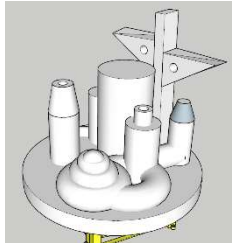

Le module traitement de l'eau grise de MARS

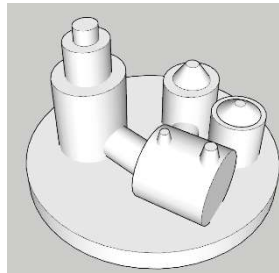

Sas rover

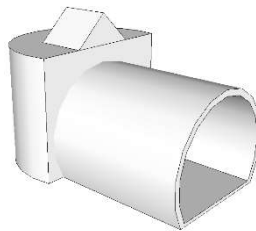

Le module nucléaire

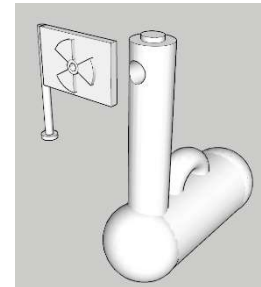

Le concentrateur de lumière pour les serres

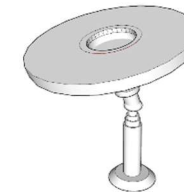

Bloc solaire

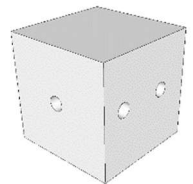

Les panneaux solaires

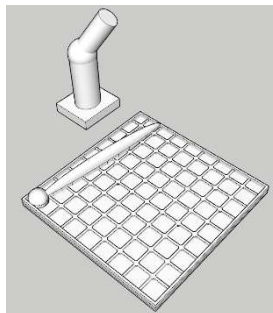

Le module recyclage des structures d'habitation

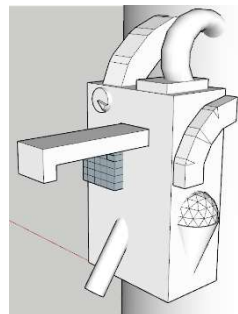

Sas scaphandre de type russe

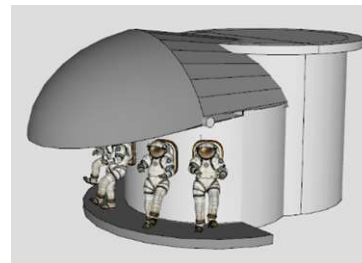

Les puis de lumière naturelle

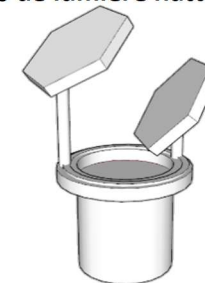

Rampe d'accès aux modules

